

Cellular Shades

LIFT STYLES

Bottom-Up Shade

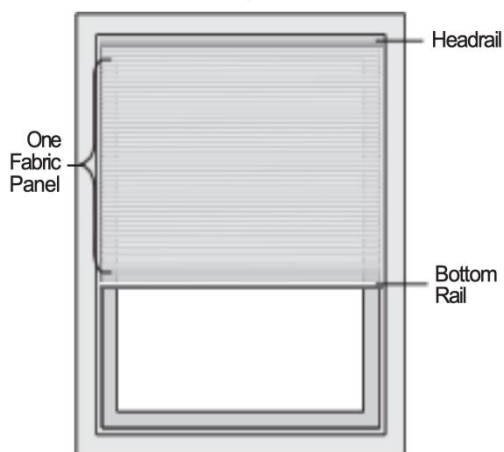

Top-Down/Bottom-Up Shade

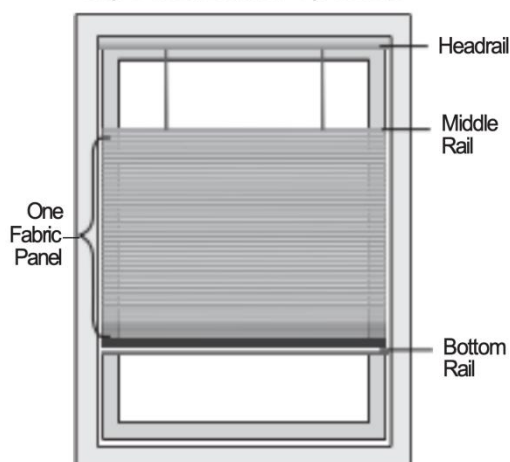

Day/Night Shade

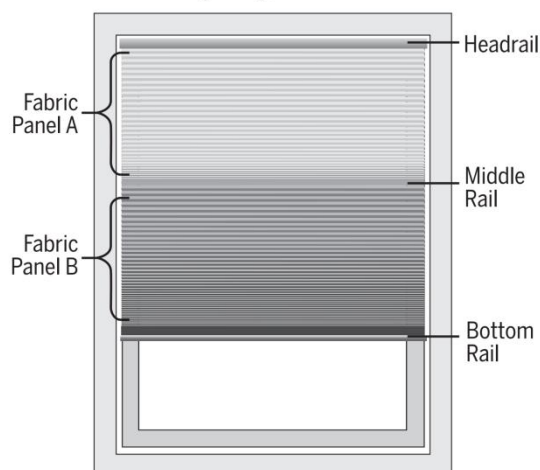

COMPONENTS INCLUDED

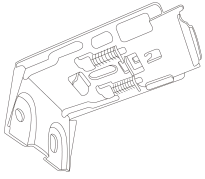

Mounting Bracket



Screws

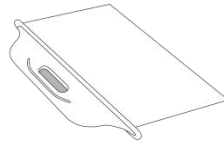

Cordless Handle

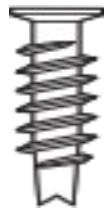

Drywall Anchors

INSIDE MOUNT

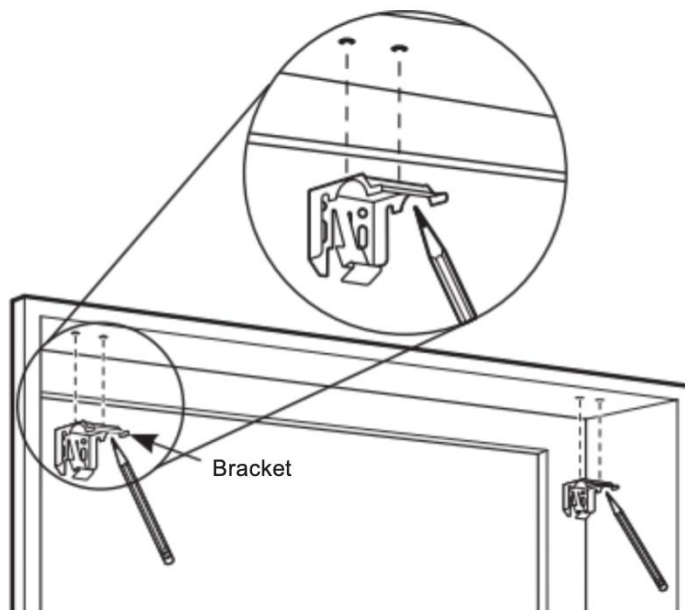

Step 1: Mark Bracket Placement

IMPORTANT: Before marking bracket locations, ensure that your bracket placement will not interfere with any components inside the headrail.

- Verify that your window casing has a minimum depth of 1 ½" which allows for a partially recessed headrail mount.
- If flush mount (fully recessed mount) is desired, a minimum mounting depth of 2 1/8 " is required.
- Mark 1 - 2" from each jamb for bracket location.
- With a pencil, mark the longer, oblong drill hole locations through the top of the holes of the bracket, 2 holes per bracket.
- If more than two installation brackets come with your order, space additional bracket(s) evenly between the two end brackets, no more than 30" apart, and mark drill hole locations.

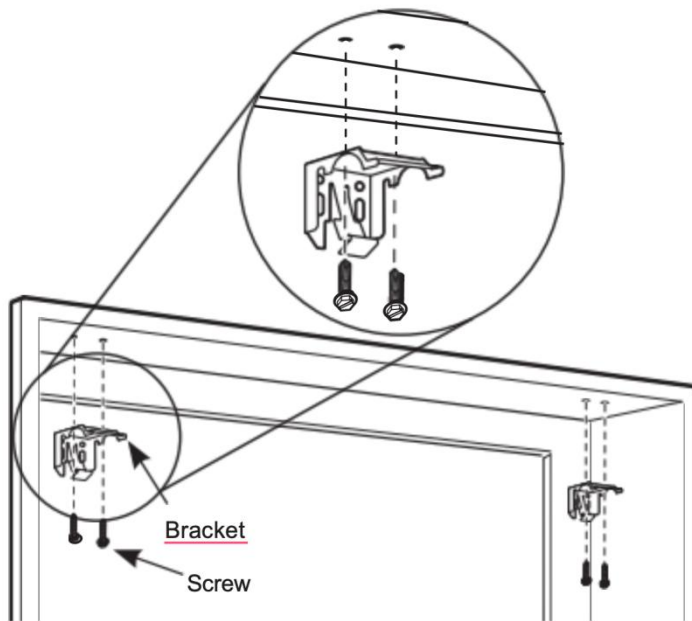

STEP 2: Installing the Brackets

- Pre-drill screw holes using a 1/16 " drill bit (wood and metal mounting surfaces only) using pencil marks as a guide.
- Hold the bracket with the surface marked "Top" facing up. Line up the pre-drilled screw holes and the longer, oblong holes in the bracket.
- While holding the bracket in place, secure the bracket with screws, 2 screws per bracket.
- Repeat for each bracket.
- Ensure all brackets are square with each other.

STEP 3: Attaching the Shade

- Slide the headrail into the bracket, making sure the headrail's lip (or edge) securely fits into the inner catch of the bracket. Push it firmly into place until you hear a "click," indicating that the headrail is securely locked.

CAUTION: Be sure the bracket and headrail are properly secured before operating the shade. Failure to do so may result in the shade falling and possible injury.

OUTSIDE MOUNT

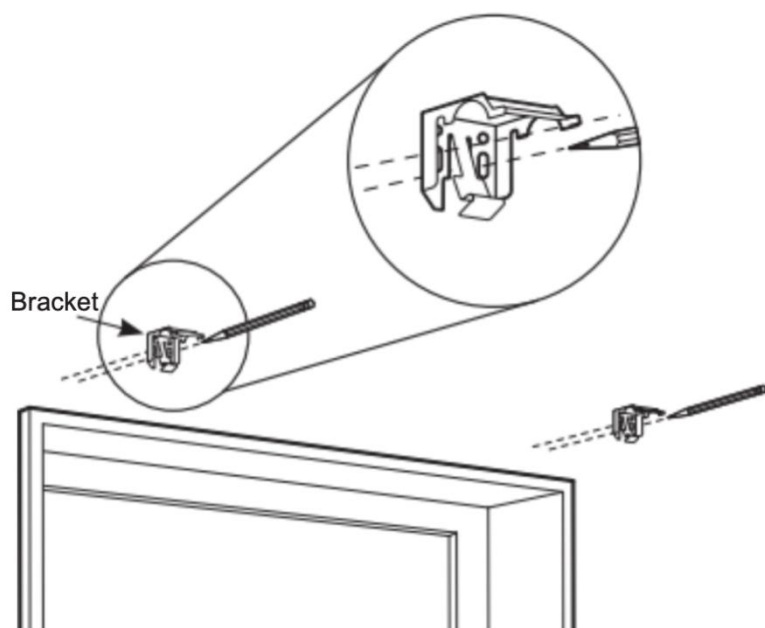

STEP 1: MARKING THE BRACKET LOCATIONS

IMPORTANT: Before marking bracket locations, ensure that your bracket placement will not interfere with any components inside the headrail. The rear of the brackets must be flush against a flat mounting surface. Do NOT mount brackets on curved molding.

- Center the headrail over the window opening at the desired height.
- Use a pencil to lightly mark each end of the headrail.
 - Alternatively, measure the width of the headrail and use that width to mark the headrail endpoints over the window opening.
- Mark approximately 1 - 2" in from each end of headrail for the installation bracket locations.
 - Allow a minimum of $\frac{1}{4}$ in. between the bottom of the installation bracket and the top of the window molding.
- With a pencil, mark the installation brackets or extension bracket screw locations through the larger, oblong rear holes of the bracket, 2 screws per bracket.
- Use a level to ensure all brackets are aligned.
- If more than two installation brackets come with your order, space additional bracket(s) evenly between the two end brackets, no more than 30" apart, mark drill hole locations.

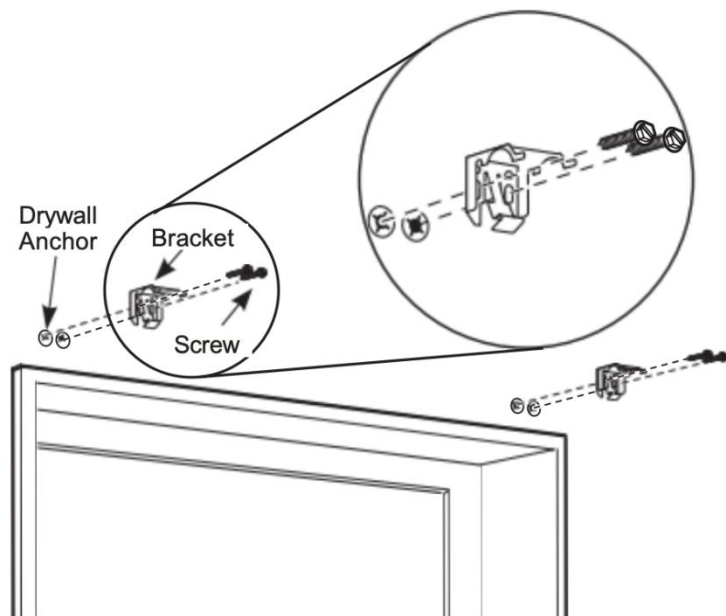

Step 2: Installing the Brackets

IMPORTANT: Use drywall anchors when mounting into drywall. The rear of the brackets must be flush against a flat mounting surface. Do NOT mount brackets on curved molding.

- Pre-drill screw holes using a 1/16 " drill bit, using pencil marks as a guide.
- While holding the bracket in place, secure with screws, 2 screws per bracket.
- Repeat for each bracket.
- Use a level to confirm all brackets are level.

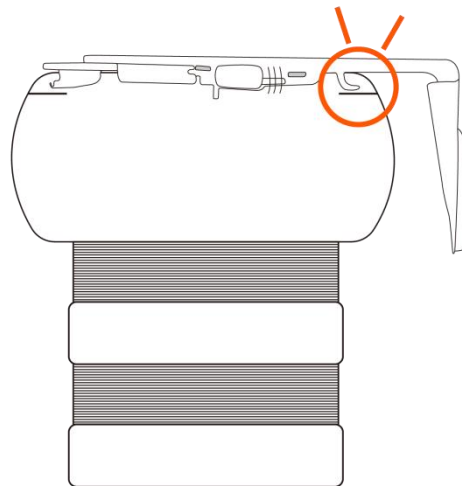
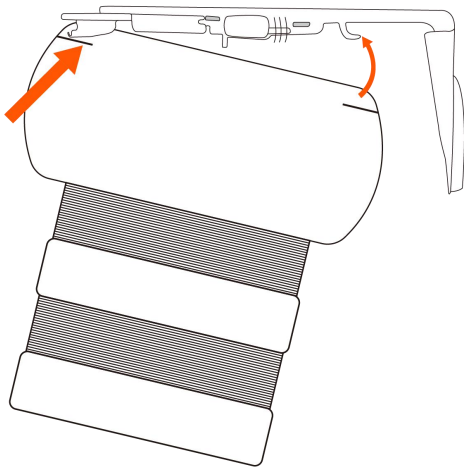

Step 3: Attaching the Shade

- Slide the headrail into the bracket, making sure the headrail's lip (or edge) securely fits into the inner catch of the bracket. Push it firmly into place until you hear a "click," indicating that the headrail is securely locked.

CAUTION: Be sure the bracket and headrail are properly secured before operating the shade. Failure to do so may result in the shade falling and possible injury.

Attach Cordless Handle

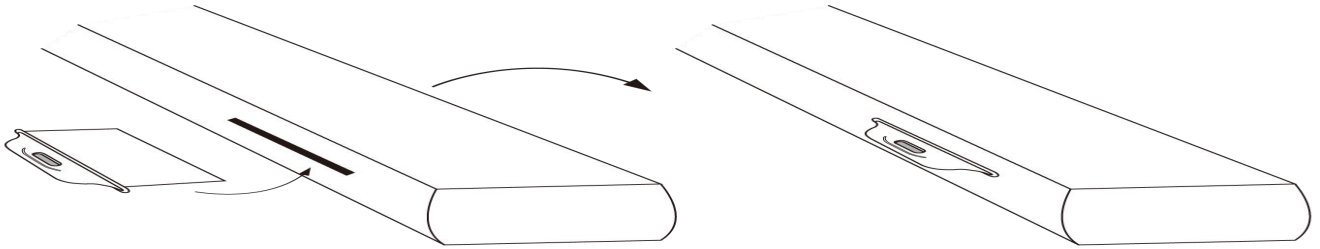

Attach the Handle to the bottom rail as illustrated. The handle is designed to minimize contact with the shade fabric. Always raise and lower the shade SLOWLY(!) to assure that the pleated fabric stacks neatly. To lower the shade: grip the bottom-rail/handle and slowly pull straight down. To raise the shade: put one hand under the bottom rail (palm facing up) and lift slowly until the desired height is reached.

Cleaning Procedures

All Sense Cellular Shades are made of 100% polyester and with multiple cleaning options, these easy to care for shades will maintain their beautiful appearance for years to come.

NOTICE: Avoid contact with window cleaning products. Improper cleaning may damage the shade and void warranty.

Dusting

Regularly clean your shades with a feather duster to remove surface dust.

Compressed Air

Use clean, compressed air to blow away dirt and debris from the fabric.

Professional Cleaning

Hire a local on-site blind or shade cleaner who uses an injection/extraction method. This process injects cleaning solution into the fabric and removes it along with dirt simultaneously. It is usually done at home, so there's no need to remove your shades.

Vacuuming

Gently vacuum the shades using a brush attachment with low suction. Lightly stroke the fabric to clean it effectively.

Spot Cleaning

For stains, use warm water and a mild soap, such as Woolite® or Scotchgard®, if necessary. Avoid immersing the shades in water to prevent damage.

WARNING

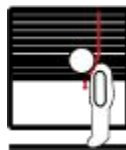

Products with a Damaged, Loose, or Missing Cord Weight Device Pose a Strangulation Risk to Children.

This Window Blind is equipped with a Cord Weight Device.

- Remove from use and repair or replace if Cord Weight Device is damaged, loose, or missing.
- Cord Weight Device must be securely attached to wall or floor.
- Children can climb on furniture to reach cords.
- Fasteners provided with Cord Weight Device may not be appropriate for all mounting surfaces.
- Use appropriate anchors for mounting surface conditions.
- Tag to be removed only by end-user.